

THIS COPY IS PROVIDED ON A RESTRICTED BASIS AND IS NOT TO BE USED IN ANY WAY DETRIMENTAL TO THE INTERESTS OF PANDUIT CORP.

PANDUIT PART NUMBER	A CONDUCTOR RANGE	WIRE DIAMETER RANGE - IN	STUD SIZE	HEX NUT	BODY HEX	H ONE CABLE	C	RoHS COMPLIANT
SP2-8-C	12 SOL - 8 STR	.081-.146	1/4-20	.50 [13]	.38 [9]	.75 [19]	0.50 [13]	YES
SP2-8L-C	12 SOL - 8 STR	.081-.146	1/4-20	.50 [13]	.38 [9]	.75 [19]	1.00 [25]	YES
SP2-7-C	8 SOL - 7 STR	.102-.164	1/4-20	.69 [17]	.50 [13]	1.00 [25]	0.50 [13]	YES
SP2-7L-C	8 SOL - 7 STR	.102-.164	1/4-20	.69 [17]	.50 [13]	1.00 [25]	1.00 [25]	N/A
SP2-4-C	10 SOL - 4 STR	.102-.232	5/16-18	.75 [19]	.56 [14]	1.16 [29]	.56 [14]	YES
SP2-4L-C	10 SOL - 4 STR	.102-.232	5/16-18	.75 [19]	.56 [14]	1.16 [29]	1.00 [25]	N/A
SP2-3-C	10 SOL - 3 STR	.102-.260	3/8-16	.81 [21]	.63 [16]	1.09 [28]	.63 [16]	N/A
SP2-3L-C	10 SOL - 3 STR	.102-.260	3/8-16	.81 [21]	.63 [16]	1.09 [28]	1.13 [29]	YES
SP2-2-C	10 SOL - 2 STR	.102-.292	3/8-16	.88 [22]	.69 [17]	1.38 [35]	.63 [16]	YES
SP2-2L-C	10 SOL - 2 STR	.102-.292	3/8-16	.88 [22]	.69 [17]	1.28 [33]	1.13 [29]	YES
SP2-1/0-L	2 SOL - 1/0 STR	.258-.375	1/2-13	1.00 [25]	.75 [19]	1.69 [43]	.75 [19]	N/A
SP2-1/0L-L	2 SOL - 1/0 STR	.258-.375	1/2-13	1.00 [25]	.75 [19]	1.69 [43]	1.25 [32]	N/A
SP2-2/0-Q	2 SOL - 2/0 STR	.258-.419	1/2-13	1.13 [29]	.88 [22]	1.88 [48]	.75 [19]	YES
SP2-2/0L-Q	2 SOL - 2/0 STR	.258-.419	1/2-13	1.13 [29]	.88 [22]	1.88 [48]	1.25 [32]	YES
SP2-4/0-Q	1 SOL - 4/0 STR	.289-.528	5/8-11	1.38 [35]	1.13 [29]	2.25 [57]	1.00 [25]	N/A
SP2-4/0L-Q	1 SOL - 4/0 STR	.289-.528	5/8-11	1.38 [35]	1.13 [29]	2.25 [57]	1.50 [38]	YES
SP2-350-12	1 STR - 350 kcmil	.332-.682	5/8-11	1.50 [38]	1.25 [32]	2.69 [68]	1.00 [25]	N/A
SP2-350L-12	1 STR - 350 kcmil	.332-.682	5/8-11	1.50 [38]	1.25 [32]	2.69 [68]	1.50 [38]	N/A
SP2-500-12	3/0 STR - 500 kcmil	.470-.815	3/4-10	1.81 [46]	1.50 [38]	3.19 [81]	1.38 [35]	N/A
SP2-500L-12	3/0 STR - 500 kcmil	.470-.815	3/4-10	1.81 [46]	1.50 [38]	3.19 [81]	1.75 [44]	N/A

NOTES:

1. MATERIAL: HIGH COPPER CONTENT HARD DRAWN ROD
2. USED FOR CONNECTING CONDUCTORS TO VARIOUS SIZES OF TAPPED HOLE
3. DIMENSIONS IN BRACKETS ARE MILLIMETERS.
4. SEE WWW.PANDUIT.COM FOR PACKAGE QUANTITIES

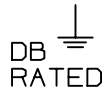
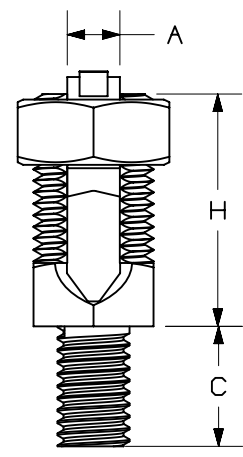

PART NUMBER		SEE TABLE	
TITLE			
BRONZE SERVICE POST CONNECTOR - SP2 SERIES			
CUSTOMER DRAWING			
ITEM REVISION NAME		N41214BA/04	
DATASET FILE NAME		N41214BA-DC/04A	
MATERIAL		SEE NOTES	
DRAWN BY		DATE	CHK
TM	7-97	TM	SCALE
NONE		SHEET 1 OF 1	
DRAWING NUMBER		N41214BA-DC	
ECN		A	

04A	7-24-23	JHNU	JHNU	MRWA	C. REVISED DRAWING NUMBER: N41214BA-DC WAS C41214 B. ADDED RoHS COMPLIANT COLUMN A. CONVERTED TO NX	133002
REV	DATE	BY	CHK	APR	DESCRIPTION	ECN