

THIS COPY IS PROVIDED ON A RESTRICTED BASIS AND IS NOT TO BE USED IN ANY WAY DETRIMENTAL TO THE INTERESTS OF PANDUIT CORP.

PANDUIT P/N	WEIGHT
PWBPS**	5.00 LBS/KIT (2268.0g)/KIT

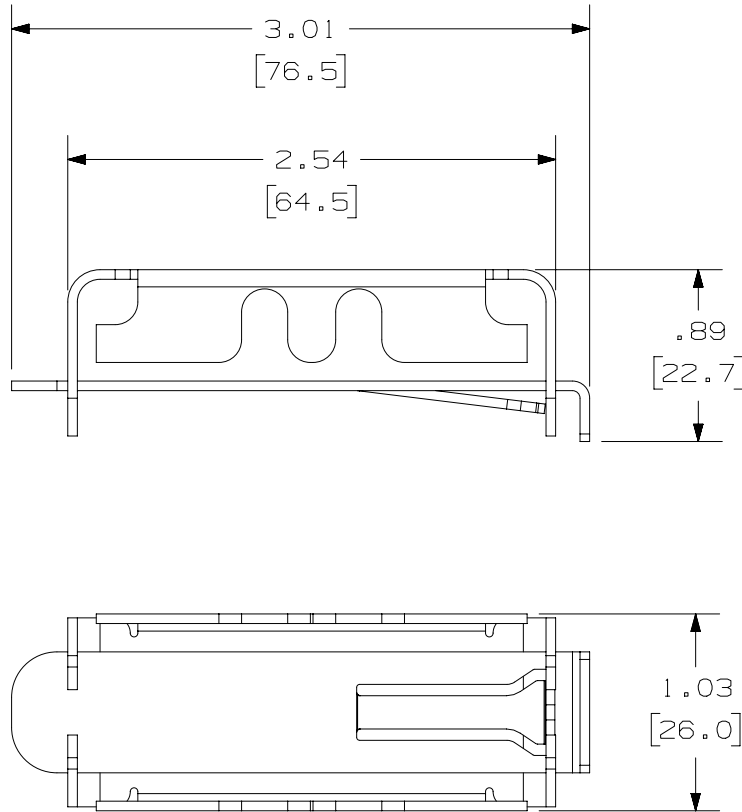

NOTES:

- VISIT OUR ON-LINE CATALOG AT [WWW.PANDUIT.COM](http://WWW.PANDUIT.COM) FOR A LIST OF CURRENT PARTS APPLICABLE FOR USE WITH THIS PRODUCT.
- DIMENSIONS IN ( ) ARE METRIC.
- ALL MATERIALS AND COMPONENTS USED MEET THE MATERIAL RESTRICTIONS OF RoHS (EUROPEAN DIRECTIVE 2011/65/EU ON THE RESTRICTION OF HAZARDOUS SUBSTANCES) AS PROPOSED BY THE RoHS TECHNICAL ADAPTATION COMMITTEE.
- PART INCLUDES:  
50- LOCKING TAB  
50- PUSH-ON SPLICE

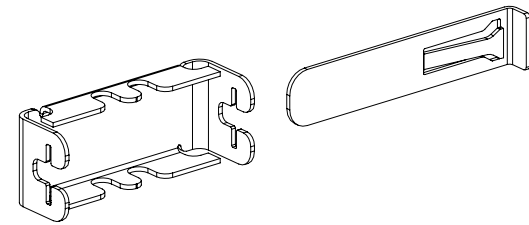

REV	DATE	BY	CHK	APR	DESCRIPTION	ECN
01B	12-14-23	SAT	DWR	EB	B. UPDATED TITLE. C. REMOVED P/N FROM TITLEBLOCK.	00510ETA-DC
01A	11/9/21	JSP	DWR	ML	A. BLACK PART NUMBER WAS PWBPSEB.	00510ETA-DC
00A	01-18-21	SAT	DWW	ML	INITIAL RELEASE	00510ETA-DC

TITLE <b>WIRE BASKET PUSH-ON SPLICE (PACK OF 50)</b> CUSTOMER DRAWING					
ITEM REVISION NAME <b>00510ETA/01</b>			<b>PANDUIT</b>		
DATASET FILE NAME <b>00510ETA_DC/01B</b>					
DRAWN BY <b>SAT</b>		DATE <b>01-15-21</b>	CHK <b>DWW</b>	SCALE <b>NONE</b>	DRAWING NUMBER <b>00510ETA-DC</b>
MATERIAL <b>ZINC PLATED STEEL</b>					SIZE <b>A</b>
SHEET 1 OF 1					

A-SIZE CUSTOMER